

# easter communications

*PDF examples of:*

# Church Overview Booklets



**Yvon Prehn**  
**Effective Church Communications**

# How and why create an overall Church Information booklet and an ebook for Easter and all-year

by Yvon Prehn, [www.effectivechurchcom.com](http://www.effectivechurchcom.com)

If you want to get church guests to come back to your church after a visit at Easter or anytime, one of the best ways to do that is to create a booklet that gives visitors an overview of your church. This is especially important for holidays because churches seldom do the same things on Easter Sunday or other holiday times that they do the rest of the year. They do special things they don't normally do (brunch, Easter activities for children, special music) and they often don't do things they normally do, such as hold adult Bible classes.

In addition to the importance of knowing what your church does on a regular basis, visitors might be very interested in what you do in your church for children, youth, women, or various interest groups on an ongoing basis. You might announce these ministries during holiday services, but so much is going on at that time, it is easy for people to forget. In addition, you simply don't have time to tell people all about the activities and ministries that might be of great benefit to them.

Flyers and other handouts serve as temporary reminders, but a nice-looking booklet is a keeper. Families might toss it in a drawer, but if they feel a need for their kids or find themselves asking questions about God, they will pull it out and check out the church.

## **Make it useful for more than one occasion**

Once you do up a booklet like the ones that follow, you can change the cover for different holidays or special occasions. In addition to changing the cover sure to stay up-to-date in the interior information as ministry events change.

Booklets like this are very easy to do in MS Publisher and with a little bit of adjusting the same booklet that works well to give away to visitors, can also be made into an ebook that you can post on your website and invite people to download and print out.

On the Effective Church Communication website is a short video (only 7 minutes) following zooms through how to do a booklet and then how to make an e-book with the finished file. It is at the link below:

<http://www.effectivechurchcom.com/2011/03/how-to-create-a-booklet-and-an-ebook-for-easter-and-all-year-a-short-webinar/>

Following are three examples of church overview booklets. One is newer, two are older but all are EXCELLENT examples of the kind of information you need to include.

**\*\*\*ONE MORE IMPORTANT THING TO REMEMBER.....**

If you can't afford to do full-color printing or even a colored cover—that is OK! It isn't the use of color or not that makes a booklet like this useful—it is the content. Work on that and even the most simple black and white publication, the Lord can use to change lives.



New Life  
PROVIDENCE CHURCH

*Welcome!*



New Life  
PROVIDENCE CHURCH  
One church, two campuses

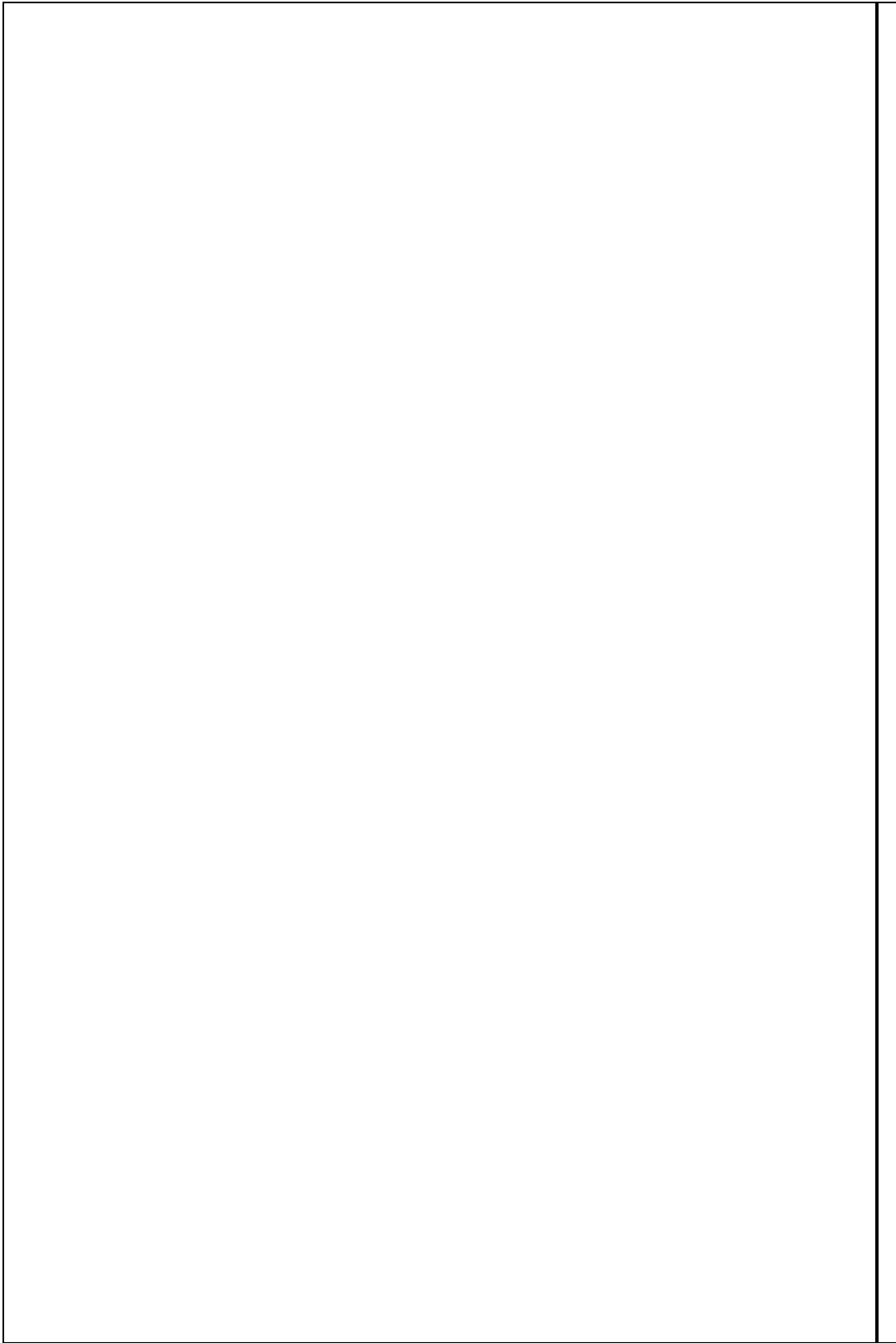

## Welcome, guests!

We are delighted to have you as a guest in our services today. Whether this is a one-time visit or the beginning of a long-term relationship with our church family, we pray that you will encounter God's presence in a very personal way.

This booklet is provided to give you an overview of our church's ministries as well as the logistical help of building diagrams and other information to help you get around a bit easier.

New Life Providence Church is a transethnic body of believers. We value diversity in every area of the ministry and we're intentional in our efforts to help members relate to one another as a multiethnic, multicultural, multi-gifted blend of God's people.

As a church, our three primary values are prayer, worship, and the Word. Our desire is to honor God by allowing those three values to permeate everything we do. If that is your heart as well, we invite you to consider New Life Providence as your new church home.

Thank you for blessing us with your presence today.

*Dan Backens*

Dan Backens  
Senior Pastor



**DEEP CREEK CAMPUS**  
**423 SHELL ROAD**  
**CHESAPEAKE, VA 23323**  
**757-673-6300**

**OFFICE HOURS: TUESDAY – FRIDAY, 9:00 AM – 5:00 PM**

SUNDAY MORNING AT 10:15 AM

Sunday morning services with Pastor Dan preaching live. Children's church program during the message portion of the service for grades 1 – 5. Middle school also meets during the message on the second and fourth Sundays.

**KEMPSVILLE CAMPUS**  
**1244 THOMPSONS LANE**  
**VIRGINIA BEACH, VA 23464**

**OFFICE HOURS: MONDAY – FRIDAY, 9:00 AM – 5:00 PM**  
**757-227-6930**

SATURDAY NIGHT SERVICE AT 6:00 PM

This is a full worship service in the sanctuary with Pastor Dan preaching live. Children's church for grades 1 – 5 during the message. The *Saturday Nite Spot* features fellowship and light refreshments after the service.

SUNDAY SANCTUARY SERVICES  
9:00 AM & 11:30 AM

Sunday morning services with Pastor Dan preaching live. The 11:30 service features the choir each week. For grades 1 – 5, graded Sunday School during the 9:00 service and children's church during the 11:30 service. Middle school meets during the message on the second and fourth Sundays during the 11:30 service..

VIDEO CAFÉ SERVICES  
SUNDAYS, 9:00 AM & 11:30 AM

Meeting in the auditorium on the west end of the building near Kids Cove, Video Café offers the more relaxed atmosphere of a coffee-house type venue. Live worship, "artsy" components, and Pastor Dan's message on live video feed. For grades 1 – 5, graded Sunday School during the 9:00 service and children's church during the 11:30 service. Coffee bar and snacks available.

INTERNATIONAL CAFÉ SERVICE  
SUNDAYS, 10:00 AM

Meeting in the multipurpose room on the east end of the building, this service has a diverse leadership team. The format includes international worship, prayer for the nations, and Pastor Dan's message via video. International refreshments following the service.

**HISPANIC SERVICE**  
**NUEVA VIDA OFFICE: 757-333-0686**

NUEVA VIDA, SUNDAYS, 2:00 PM

Under the leadership and preaching of Pastor Italo Gil, *Nueva Vida* (Spanish for New Life) conducts their weekly Hispanic worship service in the Kempsville auditorium on the west end of the building near Kids Cove.



## Children's Ministry

Our nursery provides a loving, safe environment for the youngest children while their families participate in the worship service or other church activities.

At age three, children begin participating in age-appropriate classes and begin to build a firm foundation for their faith.

First graders move into the elementary program. Each service has a different look for these children. During the 9:00 AM services at Kempsville, children are dismissed to Sunday School classes following worship. Classes are divided into grades 1-2; grades 3-4; 5th grade boys; and 5th grade girls. On Saturday nights, and during the 11:30 Kempsville services and the Deep Creek service, the first through fifth graders are dismissed to a large group children's church. International Café has a separate children's ministry system—see a greeter for details. In all classes, our goal is to equip children with godly principles from the Bible and life application lessons.

Children also have opportunities for dance ministry, missions trips, and other special events. Adults have various opportunities to mentor or tutor at-risk children in our community outreach programs.

### How can you get plugged in?

- Fill out a personal application and a request for a criminal history/sex offender record search. These are available in Kids Cove, Kids Creek, or the NLPC website.
- A personal interview with Pastor Cheryl to identify opportunities and placement. Every effort is made to find a good fit for volunteers; training provided.

**Contact:**  
Pastor Cheryl Muniz  
cheryl@newlifeprovidence.com  
757-227-6930



New Life Providence Youth Ministry



Our goal is to create a well-rounded youth ministry that has something to offer to every young person to assist them in a continued growth in their relationship with God. We strive to take the hand of each young person and connect him or her to the hand of God so that they will grasp and understand that they were created for relationship with Him.

**Core** is Project 52's high school life group mentorship program, held every Wednesday, 6:00 – 8:00 PM at both campuses.

Saturdays we have The Door, our youth group meeting for both middle school and high school, which meets at the Deep Campus. Our schedule:

5:00 PM Hangout time; café open  
6:15 PM Service  
8:00 – Hangout, bon fire,  
10:00 movies, café open, game room, etc.



## the door

On the second and fourth Saturdays and Sundays, middle schoolers have a class during the message portion of the worship services at both campuses.

Classes for middle schoolers are also offered on Wednesday evenings when Primetime is in session.

We welcome the support and participation of parents and other adults from the congregation at Project 52. Contact Pastor Liam for details.

**Contact:**  
Pastor Liam Coventry  
liam@newlifeprovidence.com  
757-227-6930



David McBride  
Middle School Director  
david@newlifeprovidence.com  
757-227-6930







We are a group of young adults between 18 and 28 who are awaking to the life-altering presence of Jesus Christ. We are, however, part of a larger movement taking place on the college campuses where students are tired, hungry, and thirsty—looking for something of substance that doesn't leave them longing for more. We are a group of young businessmen and businesswomen who are tired of an unfulfilling pursuit after the American Dream. And we are young adults who are part of a movement that cuts across every skin color and subculture.



**How We Do It:**

**823** – A ministry-wide gathering on Thursday nights at 8:00 PM. Young adults from across Hampton Roads join for worship, ministry, and fellowship with the primary goal of encountering the presence of Jesus Christ.

**Life Groups** – Deepen your Christian walk, build authentic relationships, become equipped and released in personal ministry in a small group ranging from 5-15 people who meet weekly in someone's living room, apartment, or dorm suite. And they're happening almost every night of the week.

**Outreach** –Once a month each Life Group "adopts" a nursing home, city block, soup kitchen, etc. in belief that we are Jesus' hands and feet to reach those on the fringe.

**Contact:**  
Pastor Joel Solomon  
joel@newlifeprovidence.com  
757-227-6930



## Life Groups

New Life Providence believes that weekend worship services are essential to our life as a growing congregation. However, we also believe that small home groups— life groups—consisting of 5 to 15 people, are the foundational building block of the church. Life groups are the primary means through which personal ministry, pastoral care, discipleship, and leadership development occur in our congregation.

Groups typically meet three times a month for fellowship, study, prayer, and personal ministry. Some of our groups are also involved in outreach events to the community. Many groups are kid-friendly, while others are specifically designated for adults.

The life group display in the hall outside the Kempsville sanctuary is designed to help you find a group that fits you well. You'll find that the display is divided by the day of the week that groups meet, as well as sections specifically for women's and men's groups. Help yourself to a business card from each group that looks like it might be a fit for you and call the leader for more information. Also, help yourself to a copy of our Life Group Directory from the display to review at home. Directories are available at the information center at the Deep Creek campus.



Still need help finding an appropriate group? Give us a call at the church office and we'll be glad to help.

**Contact:**  
Pastor Steve Carlin  
steve@newlifeprovidence.com  
757-673-6300





## Women's Ministry

We are a group of women who are walking together in identity, sisterhood, and community through real conversations and service. Whether 18 or 88, we want to be a legacy and leave a legacy.

Events include:

- Bible studies
- Mothers of Preschoolers (MOPS)
- Annual retreat
- DNA Young Women's Conference
- Prayer and worship events
- Annual Summer Fling—a fun summer event that takes on a variety of themes
- Periodic special events



Contact us for information on how to connect and places to serve.

**Contact:**  
Pastor Tina Davis  
women@newlifeprovidence.com  
757-673-6300



## Men's Ministry

Our men's ministry is committed to building an army of men who are men of God, men of integrity, and men of purpose.

We provide a safe environment for men to develop meaningful friendships with other men.

Events include:

- Monthly men's breakfasts
- Weekly men's prayer meeting
- "Huddle-Up" support and accountability groups
- "Top Gun" leadership training/discipleship
- Retreats
- Annual father/son picnic
- Sports events
- Outreach activities



Other special events may include attending conferences or fun trips.



There are many entry points for men to participate or serve. Contact John for details.

**Contact:**  
John D'Amelio  
men@newlifeprovidence.com  
757-436-2850



## Worship Ministry



Music is a vital part of how we bring glory to the King. The Word reveals that heaven's worship is happening...day and night without ceasing...(Revelation 4:8). We glorify God through our musical skills and creative talents, and it is for this reason we have a music ministry at New Life Providence Church.

The choir is a multi-cultural group of singers with a diversity of musical backgrounds and styles blended together for the purpose of leading the church into the courts of the Lord. The choir is open to all singers.

Worship leaders are the primary song leaders for each service. Audition is required, and worship leaders must be church members.

The musicians serve as worship leaders on their instruments, playing on a rotation basis for the weekend and various services throughout the week, including: prayer meetings, Project 52 (youth), 823 (young adults), King's Chamber, and special events. Audition is required.

Rehearsals for all singers and musicians are held on Thursday evenings. Childcare is provided.

### Contact:

Clem Abrams  
Director of Worship  
clem@newlifeprovidence.com  
757-227-6930



## Performing Arts

### Special Music – Solo/Group

If you can sing, have a band, play an instrument or have a group and want to share your gift with the church, there are outlets and places for you to showcase your gifts!

Through a screening process, we schedule special music throughout the calendar year and at various services and outlets through New Life Providence Church.

### Spoken Word/Rap/Written Word

Whether you write to rap, speak, or to have read, there is a place for words to be given to the congregation and beyond at New Life Providence. This is not a department at New Life, but it is an opportunity to share your gift with the church. Through Arts Café, Video Café, and specials during our services, we have the outlet for you to express yourself as an artist for the Lord.

### Dance

We have a dynamic dance ministry at New Life Providence Church. This is open to all ages and all levels of experience.



### Drama

Though this is not a department at NLP, we have many opportunities for drama throughout the calendar year. If you are interested in developing this ministry or getting involved on a periodic basis, please contact Pastor Tina.

### Productions

On a yearly basis, we have one or two presentations of the gospel. Whether Christmas, Easter, or another production, there are many opportunities to sing, dance, direct, assist, and even write for these dynamic services!

### Contact:

Pastor Tina Davis  
Director of Arts  
tina@newlifeprovidence.com  
757-673-6300



## Visual arts



Visual arts continue to be a value at New Life Providence Church. Reflecting the creativity of our Creator is essential to declaring Him to every tribe, tongue, and nation! Here's how we give Him glory through the visual arts:

**Sunday Morning Arts Ministry** – an opportunity for musicians, vocalists, poets, and dancers to share their gift to the body in any one of our Sunday morning services.



**Art Life** – get connected with a community of visual artists who meet monthly to create, learn, grow, and encourage one another. Contact Lisa Blatner for more information (lbatner@cox.net).

**Artist of the week**—a weekly visual artist is featured at both Video Café Services at the Kempsville campus. Contact Pastor Tina to get on the schedule.

**Arts Café**—an opportunity for church members to enjoy excellence in the arts in an inviting, wholesome, and entertaining venue that features gourmet food, visual arts, and performing arts. Watch for our announcements of Saturday evening events.

**Contact:**  
Pastor Tina Davis  
Director of Arts  
tina@newlifeprovidence.com  
757-673-6300



## MEDIA/ AUDIO



We have a wide variety of needs in media/audio.

### Media Shout/ProPresenter

- Media Shout/ProPresenter is our way of presenting words, graphics, and videos for our various services and special productions. This area has many openings and regular training sessions to learn, even if you've never run it before! No experience necessary.

### Media/Light Board

- This is crucial during transition times in our Kempsville services. This person keeps things together and acts as a spotter for communication.

### Video Announcements

- Planning/Writing
- Video Shoots
- Editing

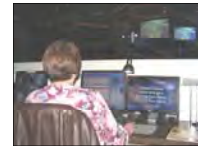

### Camera Switchboard

- We run LIVE cameras during our 11:30 AM Kempsville service and there is a professional switchboard which controls what camera is being displayed. We currently are recruiting for switchboard operators with a gifting for directing a dedicated camera team.

### LIVE Camera Crew

- We have a great camera team for you to join! We have a rotation of individuals on Sunday mornings at 11:30 AM at the Kempsville campus and at Deep Creek. Feel free to learn as you go. Training is every couple of months. Sign up now!

### Sound technicians

- With multiple services at our two Providence campuses, there are many needs for sound technicians to come on board. There is training available.

**Contact:**  
Clem Abrams  
clem@newlifeprovidence.com  
757-227-6930





New Life Providence (NLP) is wholeheartedly committed to Jesus' Great Commission mandate to "make disciples of all nations." These are our marching orders and the ultimate expression of our transethnic vision—"every tribe, tongue and nation." We have missionaries advancing the Gospel among some of the least reached peoples of the world in Asia, Africa, the Middle East, and in the heart of the Amazon. And we are committed as never before to mobilizing and releasing our congregation for even greater impact. How are we doing this?

- By **praying** for and financially **supporting** our outstanding missionary force around the world.
- By **identifying, raising up** and **training** new missionaries from our congregation through New Life School of Missions (NLSOM) and other equipping venues.
- By **sending** hundreds from our congregation every year on a wide variety of short-term missions trips.
- By **mobilizing** every member for meaningful involvement in God's global cause through prayer, missions exposure, equipping, and ministry opportunities throughout the year.

The following inscription was found on the Berlin Wall before communism collapsed and the wall came down:

*"Many small people, who in many small places, do many small things, can alter the face of the world."*

Would you like to get involved? Contact Doug Chandler for more information.

God invites us to be world changers in 2011! Will you join us? As this year's missions theme states: ***Now is the time!***

**Contact:**  
Doug Chandler  
Director of Missions  
dougchandler1@gmail.com  
757-227-6930



## Prayer Ministry

At New Life Providence we believe that:

1. Every Christian is called to be an intercessor.
2. Prayer should be born out of intimacy with God.
3. There should be diversity in prayer.
4. Perseverance in prayer builds faith for life's battles.
5. New Life Providence is a small part of what God is doing worldwide in prayer.

### IMPORTANT PRAYER MEETINGS:

**Sunrise Prayer • Wednesdays, 6:30 – 7:30 AM in the Kempsville sanctuary AND Fridays, 6:30 – 7:30 AM in the Deep Creek chapel.** These are the main prayer meetings of our church.

**Soaking Prayer •** Soft, intimate worship music will help quiet your soul and draw you to Him.

- **Mondays, 7:00 – 9:30 PM in the Kempsville sanctuary**
- **Wednesdays, 7:00 – 9:00 PM in the Deep Creek multi-purpose room (200)**



### The King's Chamber •

**Fridays, 7:30 – 9:30 PM in the Kempsville auditorium:** This is a harp (worship) and bowl (intercession) style meeting, as described in Revelation 5:7 – 9. We seek to encounter the Living Word while coming into agreement with His written Word.

### Pre-Service Prayer:

- **Saturdays, 5:30 PM, Kempsville**
- **Sundays, 8:30 AM, Kempsville**
- **Sundays, 9:45 AM, Deep Creek**

**Additional Prayer Meetings** are listed on the church website.

**August • A Month Dedicated to Prayer**  
August is dedicated to helping us encounter God more intimately. Special equipping and prayer meetings led by guest speakers impact our lives, releasing us from the past, and empowering us to pray effectually.

Volunteers are welcome in the prayer ministry! Contact Pastor Melvin if you would like to serve in any capacity.

**Contact:**  
Pastor Melvin McCleese  
melvin@newlifeprovidence.com  
757-673-6300





## Water Baptism



New Life Providence encourages all believers to be baptized in water to give public testimony of their faith in Jesus Christ.

NLP typically holds three water baptisms per year. The largest is in July and is held at an outdoor venue. Baptism services are held in the fall and winter at the church building. Contact Annette Bowen regarding the schedule.

Elementary age children are welcome to be baptized, but they are required to complete the children's water baptism class first. A class is held a week or two before each water baptism service. For details on the children's water baptism class, contact Pastor Cheryl Muniz at [cheryl@newlifeprovidence.com](mailto:cheryl@newlifeprovidence.com) or 227-6930.



**Contact:**  
Annette Bowen  
[annette@newlifeprovidence.com](mailto:annette@newlifeprovidence.com)  
757-227-6930



## CHURCH MEMBERSHIP



*New Life Providence Church* encourages all who know the Lord and who share the vision of this ministry to consider becoming church members. Membership provides many wonderful benefits and has reasonable responsibilities. Membership is open to those age 18 and older. It is a simple process.

**Discovery Seminar** is a fast-paced, on-point event, which is required for all those seeking membership in order to understand the history, values, and practices of our church. To streamline the process, the Discovery Seminar is scheduled in two parts: an all-day Saturday event (a light breakfast, lunch, and childcare provided), plus the Sunday evening *two weeks later*. You will have the opportunity to meet many of our staff pastors and directors and to have some up-close-and-personal time with Pastor Dan.

Discovery Seminar is normally held three times each year—winter, spring, and fall. To allow us to plan appropriately for childcare and meals, pre-registration is required. Brochures with more details and registration forms are available at the information center.

Information regarding the Discovery schedule is available at the information centers or contact Annette Bowen at the church office.

**Contact:**  
Annette Bowen  
[annette@newlifeprovidence.com](mailto:annette@newlifeprovidence.com)  
757-227-6930



## Outreach

All Christians need to be filled with the compassion of Christ. We are *all* called to visit the sick, the shut-in, the elderly, and those in the prison. Jesus said to go and make disciples of all nations; we start with our Tidewater area. We must put legs on our prayers and go to the lost and needy.

The goal of the outreach ministry is to train soul winners and lovers of Jesus to share this faith, and to bring the harvest into a community of believers. We are partnering with local outreach ministries to help pull in the net. We need *you* to join us and become a netcaster for Jesus.



We have a wide variety of outreach opportunities available. **Brochures listing various opportunities are available at the information center.**

### MENTORING & TUTORING

Many from our church are making an impact in the community by serving as mentors and tutors. We have a long-standing relationship with Thurgood Marshall Elementary School in Chesapeake through which we provide mentors for at-risk elementary children in a program called Kids Hope. In addition, the Life Enrichment Center, an urban outreach center in Norfolk that is affiliated with New Life Providence, provides literacy tutors for elementary students and mentors for at-risk middle schoolers.



To learn more about these programs, contact Pastor Cheryl ([cheryl@newlifeprovidence.com](mailto:cheryl@newlifeprovidence.com) or 227-6930) regarding Kids Hope, or Pastor Kevin ([kevin@newlifeprovidence.com](mailto:kevin@newlifeprovidence.com) or 623-6001) for information about the LEC.

#### Contact:

Pastor Melvin McCleese  
[melvin@newlifeprovidence.com](mailto:melvin@newlifeprovidence.com)  
757-673-6300



## New Life Providence Church

## EQUIPPING

Paul makes it clear in the book of Ephesians that Jesus wants his saints fully equipped for the work of ministry. Here at Providence, equipping means more than education. We want your families to be healthy and strong, your ministries to flourish, your marketplace influence to expand, and your lives to be truly transformed by the power of Christ.

Primetime offers a six-week intensive classroom opportunity to help you sharpen your skills and grow in the Word. Three times a year we offer classes at both the Kempsville and Deep Creek campuses. On Wednesday nights at Kempsville, programs for youth and children make it a night for the whole family.



Additional opportunities:

- Periodic seminars, conferences, forums, business luncheons, and retreats
- For those new to the faith, two specifically designed classes: *Becoming Disciples of Christ* and *Knowing the Holy Spirit*
- For those who function at NLP in a leadership position, we provide six Leadership Huddles each year to infuse leaders with vision, practical leadership training, and access to church developments that affect their roles. Each ministry department also provides training for its leaders.
- The New Life School of Missions has a training program available for those called to a full-time career in missions.
- The Church Multiplication Center (CMC) offers training and coaching for those who have a heart to plant churches.

#### Contact:

Pastor Steve Carlin  
[steve@newlifeprovidence.com](mailto:steve@newlifeprovidence.com)  
757-673-6300





# the Arts CAFE

NEW LIFE PROVIDENCE CHURCH

The Arts Café was created as a venue to release creative expression at New Life Providence. We have hosted events spotlighting music/jazz, dance, dinner theater, comedy, film, and our church's own visual artists.

Each event features incredible culinary and baking creativity, under the leadership of Mark Nowak and Beth Howell, and some form of visual art. The threefold purpose of ARTS CAFE is:



1. To create a safe venue where the creative arts can be expressed and appreciated.
2. To create a venue to release and feature artists within the church and body of Christ.
3. To create a venue where outreach would be non-threatening and inviting.

Events are held about once a month during the school year.

We are excited about the the growth that our Creative/Creator God intends for both artists and appreciators of the arts!



Contact:  
Pastor Tina Davis  
tina@newlifeprovidence.com  
757-227-673-6300



## Did you know...

...that Pastor Dan and Pastor Wayne are both from South Dakota?



...that NLP attendance has risen more than 170% since the move to the Kempsville campus in 2005?

...that Pastor Melvin and his wife Denise met while they were both in the military stationed in Germany?

...that Pastor Joel actually does own shoes?



...that the Kempsville campus used to be the Tidewater Hebrew Academy?

...that Pastor Tina used to sing backup for Ron Kenoly?

...that five Providence staff members have served as long-term missionaries?

...that Pastor Kevin is also a professor of psychology at Tidewater Community College?



...that six of our staff members are grandparents while five have children under age 3?

...that Pastor Cheryl is the pastor married the longest while Pastor Steve is the pastor married the shortest time?

...that over 300 babies/children have been born to or adopted by New Life Providence families in the last ten years?

**What unique facts could YOU bring to the New Life Providence church family?**

# Kempsville Campus

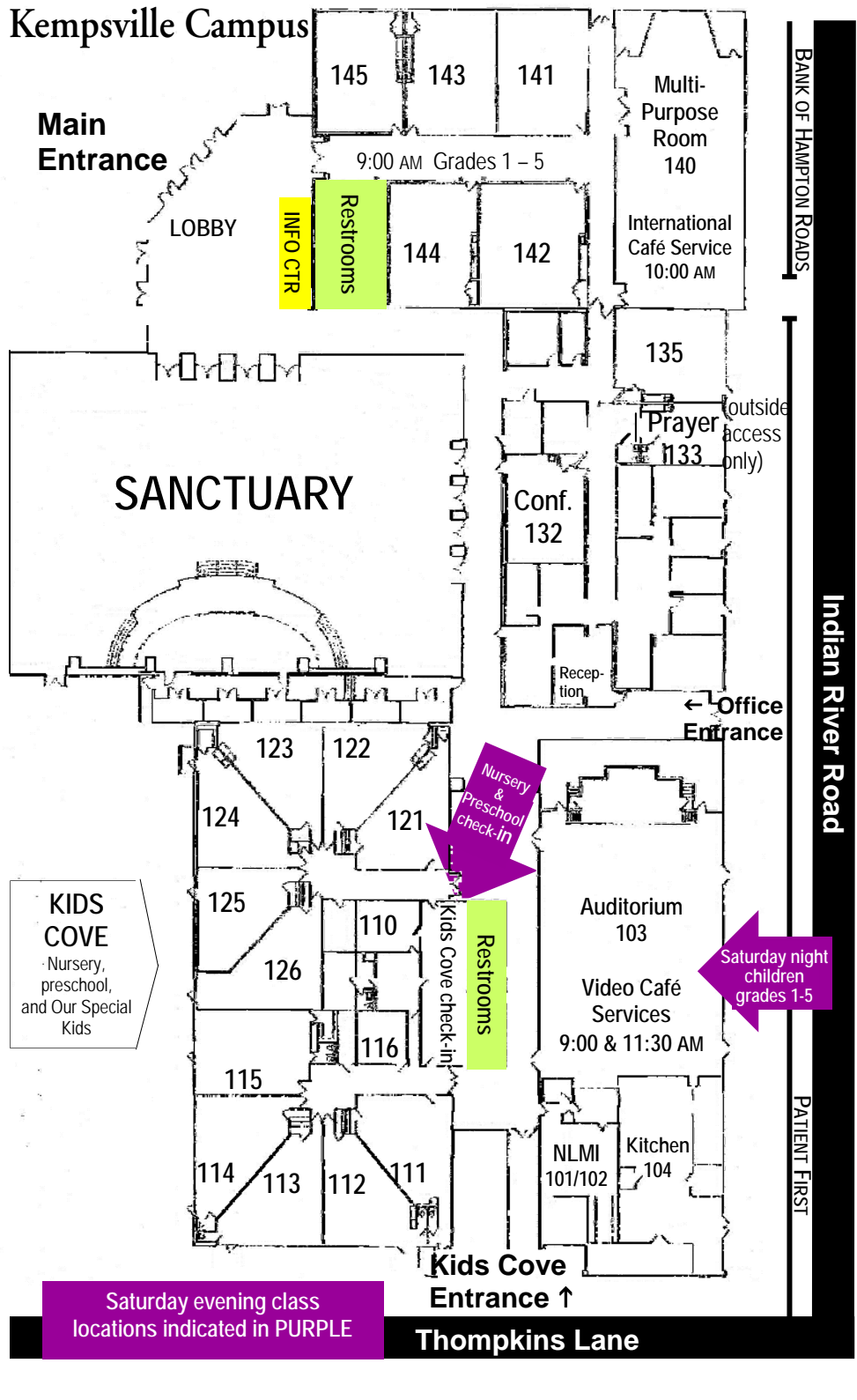

**Main Entrance**

LOBBY

INFO CTR

Restrooms

145

143

141

9:00 AM Grades 1 - 5

Multi-Purpose Room 140

International Café Service 10:00 AM

144

142

135

Prayer 1133

(outside access only)

Conf. 132

Reception

Office Entrance

SANCTUARY

123

122

124

121

125

110

126

116

115

114

113

112

111

Nursery & Preschool check-in

Restrooms

Kids Cove check-in

Auditorium 103

Video Café Services 9:00 & 11:30 AM

Saturday night children grades 1-5

**KIDS COVE**  
Nursery, preschool, and Our Special Kids

NLMI 101/102

Kitchen 104

Kids Cove Entrance ↑

Saturday evening class locations indicated in PURPLE

Thompkins Lane

BANK OF HAMPTON ROADS

Indian River Road

PATIENT FIRST

## In the Know About the Kempsville Campus Traffic Flow!



The mission of the parking ministry ensures a **smooth, stress-free** and **safe** traffic flow, thus enabling our members to participate in the worship service and anticipate God's blessing in their lives.

We strive to accomplish this mission by implementing two main principles of operation: **one-way traffic** and **reserved parking for Kids Cove**.

In this way we can keep our most vulnerable attendees out of harm's way and minimize the delays, conflicts, and accidents that can adversely affect your approach to worship.

You can help us help you!

During our services, please:

- ◆ Observe one-way traffic pattern **whether or not** a parking attendant is in view.
- ◆ Refrain from parking in the Kids Cove reserved area unless you have a child to drop off in the nursery, **whether or not** a parking attendant is in view.
- ◆ Do not speed.
- ◆ Pull into a parking spot instead of backing up when there are cars behind you.
- ◆ Use your turn signals so others know how to anticipate your movements.
- ◆ Do not text-message while driving!
- ◆ When walking across the roadway, keep your group together and go directly across.
- ◆ Stay out of handicap parking spaces unless you have a disabled person in your car.
- ◆ Ask a parking attendant for help if you have a need for special consideration contrary to the traffic pattern in effect.

Thanks!

# Deep Creek Campus

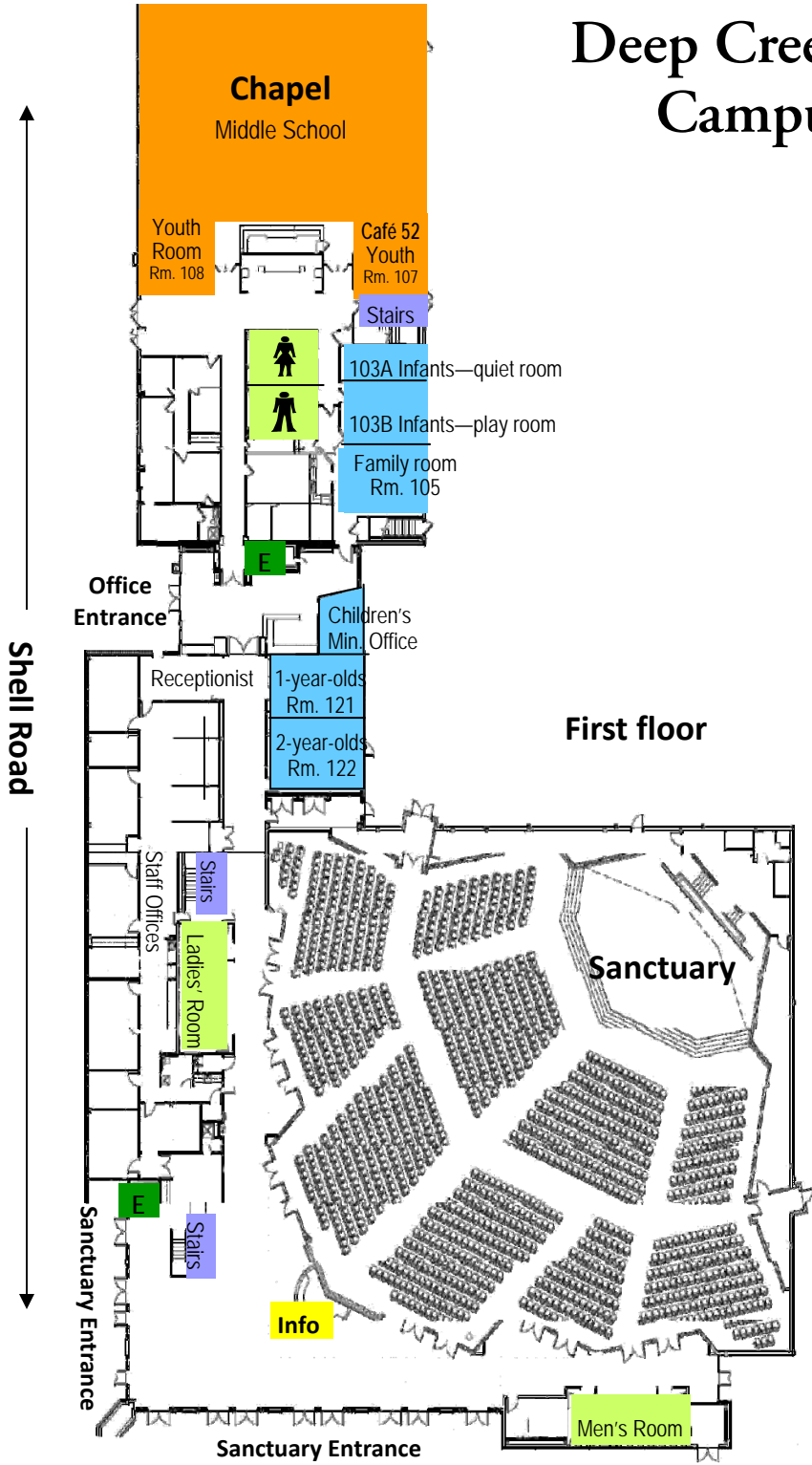

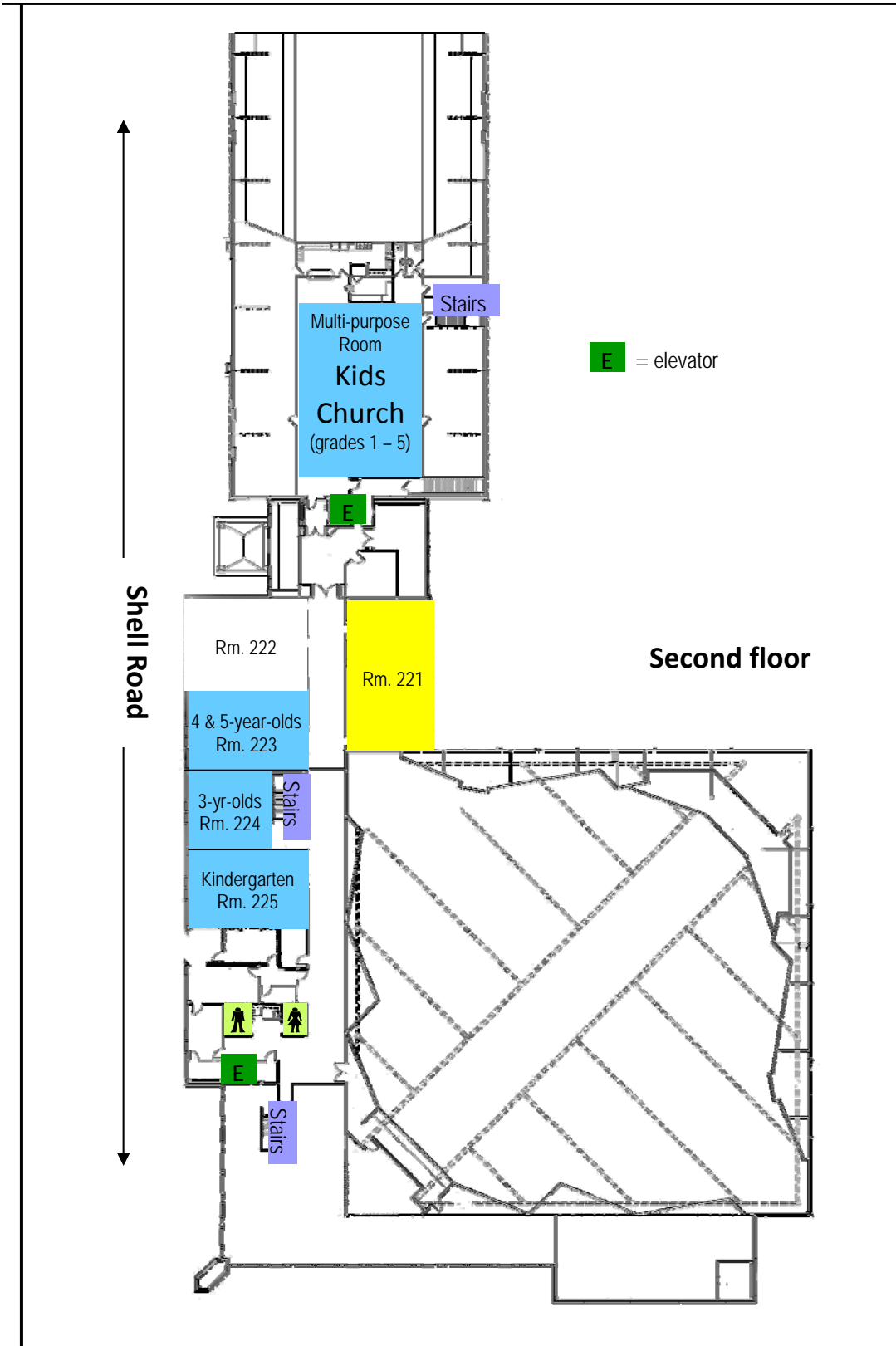

# Providence Code Breaker

Every group, over time, develops its own specialized vocabulary. Athletes, musicians, and politicians all have insider phrases, but so do church members. Here are some of the codes at New Life Providence (NLP):



**Transethnic** – a word that is not in the dictionary, but we use to mean “moving beyond (*trans*) our cultural and ethnic backgrounds to a culture of full partnership and mutual respect in the kingdom of God”

**Soaking** – a type of prayer where you rest in the Lord’s presence rather than filling your prayer time with a lot of words

Other Providence prayer terms:

**King’s Chamber** – A prayer meeting incorporating worship and intercession in a style described in Revelation 5:7-9. Some churches call this “harp and bowl.”

**Refuge Prayer** – Also known as altar ministry, this is an appropriate place for you to bring personal prayer concerns.

**Month of Prayer** – Each year August is designated as the month of prayer for NLP. Our normal church schedule is set aside for this powerful prayer emphasis.

**Life Group** (cell group) – a small group of 5 to 15 people who meet weekly to share their lives together

**Kids Cove** – the children’s ministry headquarters at the west end of the Kempsville building (toward Thompkins Lane)

**Kids Creek** – the children’s ministry headquarters at the north end of the Deep Creek campus

**Kids Hope** – a national program to match adult mentors with student mentorees. We have about 75 adults working with students at Thurgood Marshall Elementary School under Pastor Cheryl Muniz.

**PJ/52 or Project/52** is the name of our youth program.

Terms used within the youth program:

**The Door** – service for middle school and high school students on Saturday nights

**Core** – small groups for high schoolers that meet on Wednesday nights

**Awake** – the name of our young adult ministry, ages 18 to 28

Other Awake terms:

**823** – a weekly gathering of young adults for worship, ministry, and fellowship.

**LEC** = Life Enrichment Center, an urban outreach ministry in Norfolk led by Pastor Kevin Turpin

**Primetime** – the classroom-based equipping program for adults (primarily midweek, with a few classes offered at other times)



**Discovery** – a two-part seminar all new members are required to attend

**NLMI** = New Life Ministries International. This is the group of churches New Life Providence belongs to.

Some NLMI terms:

**NLSOM** = New Life School of Missions, a training program for those called to missions, offered to all New Life churches

**CMC** = Church Multiplication Center, a program for training leaders for church plants, church expansions, etc.

**Video Café** – a Sunday service that has live worship and a video sermon in a coffee house ambiance with an arts emphasis

**Arts Café** – an event facilitated by Video Café that occurs about once a month on a weekend. Each evening event offers freshly prepared gourmet food and a program with an arts emphasis.

**International Café** – a Sunday service that caters to those from other nations and others with a heart for internationals.

**Meet and Greet** – this is a 4-minute transition time right before the sermon used to casually visit with others.

**Nueva Vida** – a Spanish-speaking church that hold its services in the NLP Kempsville auditorium

**PPUMC** (Park Place United Methodist Church) and **Judeo Christian Outreach Center** are two local centers for outreach to homeless and the needy. **PIN** (People in Need) is another local ministry reaching out to the needy. NLP regularly works with these programs in outreach activity.

**Leadership Huddle** – a gathering of NLP leaders occurring approximately once a month during the school year

**Living Waters** – the name of our dance ministry

**MOPS** = Mothers of Preschoolers, a program for mothers of children age 0 – 5

**Moppets** is the name of the program for children during MOPS meetings

**SALT** or **Falling Forward** – a closed, confidential group to break men free from addictions

**Holy Ghost Wiener Roast** (aka HGWR) – Providence's annual event on October 31st on the grounds of Triple R Ranch in Chesapeake

**24/7 Prayer Room** refers to a room at the Kempsville campus that is set aside for prayer around the clock. Contact the church office for instructions on access.

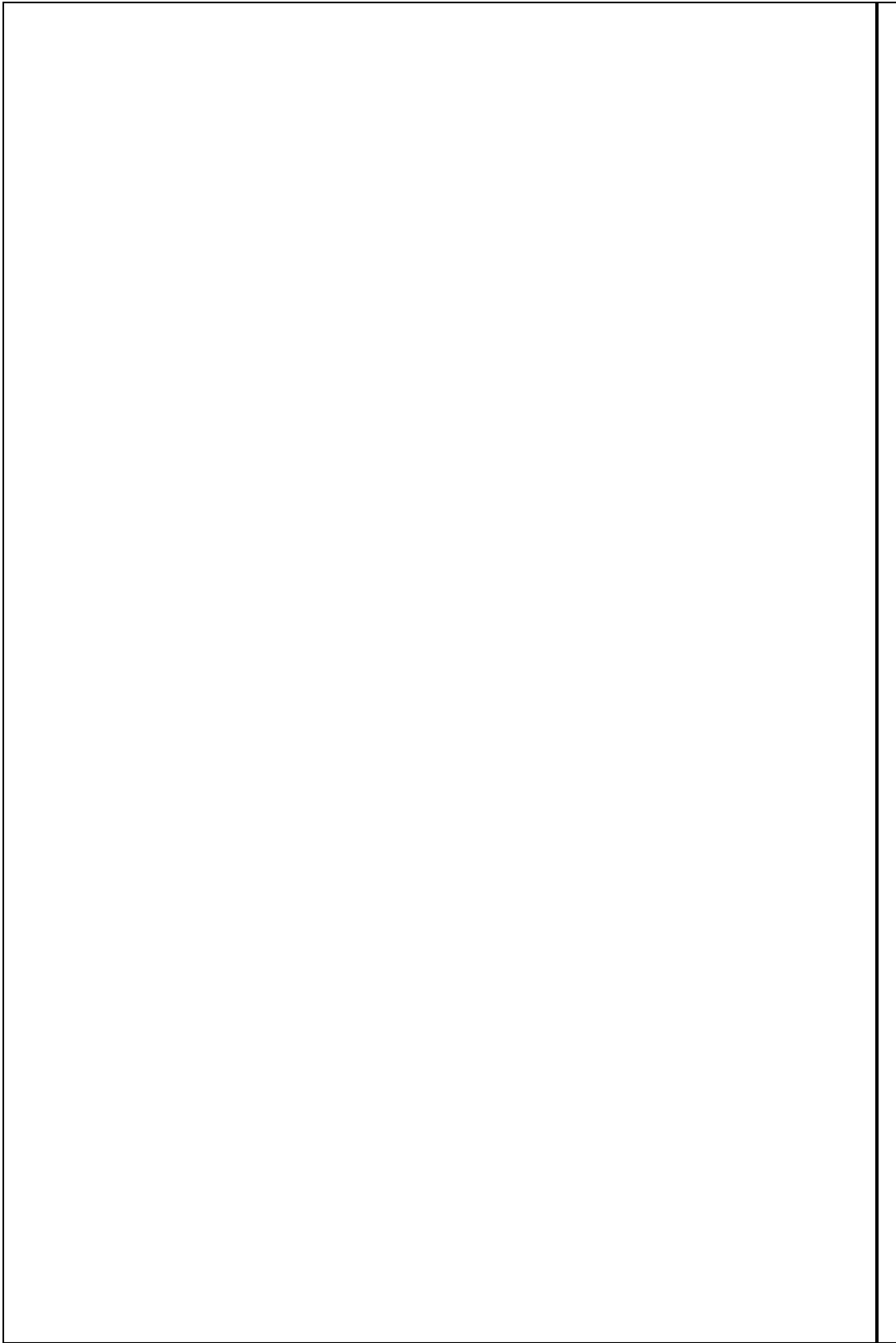





# *Easter* 2001

Calvary Baptist Church



# Easter

2001

## Welcome to Easter Sunday at Calvary Baptist

9:45 am, 11:15 am, & 6:00 pm

CHOIR & ORCHESTRA ..... "Crown Him with Alleluias"

RESPONSIVE READING ..... "The Lord Is Risen"

HYMN 215 ..... "Alleluia! Alleluia!"

HYMN 217 ..... "Christ the Lord Is Risen Today"

HYMN 105 ..... "He Is Lord"

QUIET MEDITATION

CHOIR..... "The Lamb Has Overcome"

OFFERTORY ..... Bethany Butters

"Redeemer"

SCRIPTURE

HYMN 213 ..... "Because He Lives"

MESSAGE ..... Pastor Jim Jeffery

"No Fear of Death"

"Hallelujah, Praise the Lamb"

HYMN 37 ..... "Hallelujah Chorus"



# Table of Contents

|   |   |       |
|---|---|-------|
|  | How to Receive the Amazing Hope of Easter ..... | 1-3   |
|   | Children's Ministry .....                       | 4-5   |
|   | Student Ministries .....                        | 6-7   |
|   | Single Adults .....                             | 8     |
|   | Music & Drama .....                             | 9     |
|   | Men's Activities .....                          | 10    |
|   | Women's Activities .....                        | 11    |
|   | Spiritual Growth .....                          | 12-13 |
|   | Missions/Outreach .....                         | 14    |
|   | Personal Care & Membership .....                | 15    |



## *How to Receive the Amazing Hope of Easter*



1. "For all have sinned and fall short of the glory of God." Romans 3:23
  
2. "For the wages of sin is death (hell), but the gift of God is eternal life in Christ Jesus our Lord." Romans 6:23
  
3. "In reply Jesus declared, 'I tell you the truth, no one can see the kingdom of God unless he is born again.'" John 3:3



4. "Jesus answered, 'I am the way and the truth and the life. No one comes to the Father except through me.'" John 14:6

5. "That if you confess with your mouth, 'Jesus is Lord,' and believe in your heart that God raised him from the dead you will be saved. For it is with your heart that you believe and are justified and it is with your mouth that you confess and are saved. As the Scripture says, 'Anyone who trusts in him will never be put to shame.'" Romans 10:9-11

6. "And he (Jesus) died for all, that those who live should no longer live for themselves but for him who died for them and was raised again." 2 Corinthians 5:15

7. "Here I am! I stand at the door and knock. If anyone hears my voice and opens the door, I will come in and eat with him, and he with me." Revelation 3:20

If you have read and understand that Jesus Christ is your one and only way to receive the gift of salvation,  
then pray this simple prayer:

*"Lord Jesus, I know I am a sinner. Thank you for dying on the cross for my sins. I open the door of my life and receive you as my Savior and Lord. Take control of my life and help me be the kind of person you want me to be.*

*Amen."*

**NOW WHAT?** If you have recently accepted Christ as your Savior or would like to know "How to Begin a Relationship with Christ," our NEW BELIEVER'S MINISTRY is here to serve you. To find out "How to Begin a Relationship with Christ," simply check the appropriate box on the CBC welcome card. We will send some materials and follow up on your inquiry. We are here to help you grow so you can enjoy the happiness God has promised you.

**4-Week Basic Bible Studies** If you or someone you know is interested in a relaxed and informal beginner Bible study where any and all questions are welcomed, then these studies are for you! These 4-week studies meet at various times and locations. Call the Outreach Office, 243-3674, for the latest schedule for existing and upcoming groups.

**New Believer Packs** If you or someone you know is interested in what it takes to get started on the right foot with God, contact the Outreach Office, 243-3674, for a FREE New Believers Pack.

**Christianity 101** This class is designed for new believers and meets each Sunday morning at 9:45 am. Contact Tim & Beth Nesseseth at 669-6873.

**New Believers Bible Study** Small groups meeting to study the Bible at church and in various homes. Time is spent answering the questions of new believers. Sunday Mornings, 11:15 am; Wednesday nights, 7-8:00 pm, fall & spring. Contact Pastor Scott Bixby at 243-3674.



To lead young people into a growing devotion to God; a meaningful direction in life; and a burning desire to impact others throughout their transitional years is our goal. For more information on any of these events or activities, call Carolyn at 243-3674.

**Get Involved!** We want you involved! We'll do what it takes to get you "plugged in" to our Jr. High or Sr. High school groups. At first, we may appear large but you'll soon find it's a great place to call "home." Come on out and give us a try!

**Student Impact** Every Sunday morning at 9:45 am the Sr. High Youth (9-12th grade) meet together in room 27 for a time of praise, worship and teaching!

The Jr. High (7th-8th grade) Youth meet at 9:45 and 11:15 am in room 17/19 every Sunday for their Bible Fellowship.

**Camp Calvary** - This summer GET UP and spend a week at Camp!

Jr. High - July 9-14 at Camp Calvary

Sr. High - July 2-7 at Camp Calvary

**Sr. High Mid-Week Small Groups** Sr. Highers have the opportunity to be involved in a Small Group Bible Study. The Bible studies are held in the homes of members of Calvary and are excellent times for building relationships and growing in Christ through the study of His Word!

**Jr. High** The Jr. High mid-week activity is held in Bengert Hall. This is a time of fun, fellowship and small group teaching.

**Share & Care** Activities held once a month after Sunday evening services at a family's home. Teens spend time together singing and worshipping our great God. Encouragement, games, growth, food and fun are all a part of the evening.

**Turkey Classic** This Jr. High all-night activity for grades 7-8 takes place on Nov. 16.

**Youth Handbells** Rehearsals are on Sundays. Contact Mike Gregory at 949-5849.

**In Focus** May 20, 6:00-9:00 pm. Junior and Senior High outreach activity.



**Praise Band** Join in leading worship in the Sunday morning Sr. High Bible Fellowship in Bengert Hall. This special ministry involves the teens in leading our Youth Group in singing and worship through music!

**Teen Evangelism** Training teens to share their faith is the first step in seeing teens reach teens for Christ (Monday evenings).

## Ministry Teams

There are various ministry opportunities offered each summer, including local and overseas ministry. Contact the youth office for more details.

**Camp Engineers** Each year twelve Sr. High teens are selected to be engineers at Camp Calvary. This involves intense training in a wide range of skills as well as growing in their Christian life!

**Day Camp Staff** This ministry is run for grade school children. The Sr. High youth group is heavily involved in this ministry each year.

**Wilderness Trip** A week-long trip in Colorado in August designed to move people from familiar surroundings and put them in new and challenging situations.

## Sports

**Softball** This year the Sr. High has entered both a Men's and a Coed softball league. Games begin on May 8th!

**Football** Last year the Sr. High was represented well in the Flag Football Tournament - this year will be no different! Leagues begin in September with the tournament scheduled for October.

## College

**College ABF** Our college students meet each Sunday morning at 11:15 am for a great time of fellowship, worship and learning.

**College LIFE** Students get together regularly to enjoy times of fun, food and fellowship away from the church setting.

**College Bible Studies** The women's group meets on Thursday at 8:00 pm at Cheryl Elmer's home. The men's group meets on Tuesday nights at Panera Bread across from Eastbrook Mall at 7:00 pm.



Questions about the Singles Ministry?  
Contact the church office at 243-3674

**CWC** "Connecting With Christ" is a group for those in their upper 30's and beyond. Contact *Daniel Thomas* for more information at 452-5455.

**Providence Class** is a post-college group of singles primarily in their 20's. They meet on Sundays at 11:15 am to strengthen relationships with others, to point each other toward Christ and to open their vision to the needs of others. For more information, contact *Gary Brewer* at 667-1781.

**R.O.C.K.** Early 20's class that meets in room 40. Contact *Rick Godwin* at 249-8397.

**Single Ladies Fellowship** Contact *Sue Huls* at 241-2366 for more information.

**His Hands** Helping single women with home/auto repairs. Contact *Sue Huls* at 241-2366 or *Ed Schwenke* at 949-3941.

**Adult Bible Fellowships (ABF's)** All classes are open to all single adults. 20+ age groups are offered. Contact *Evelyn* at 243-3674.



**Adult Choir** Sings in the morning services, practices Sunday morning and afternoon. Contact *Pastor Emery* at 243-3674.

**Adult Handbells** Rehearses Wednesdays and plays once a month in the Sunday services. Contact *Mike Gregory* at 949-5849.

**Orchestra** Join this ministry and play twice a month Sunday mornings. Contact *Pastor Emery* at 243-3674.

**Solos & Ensembles** both instrumental and vocal. Contact *Pastor Emery* at 243-3674.

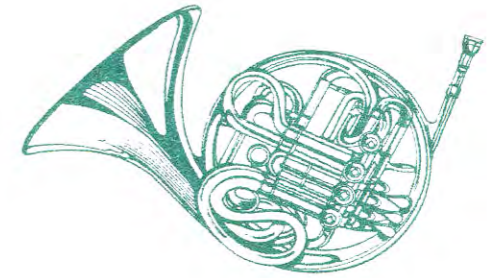

**Drama** Be involved in producing sketches and full-length productions. Contact *John Miedema* at 452-8146.

**Children's Music Ministries** See page 5

**Youth Music Ministries** See page 6-7



## Evening in December



**Softball Leagues & Tournament** CBC has 10 men's softball teams designed for outreach. These slow pitch leagues feature a 10-game season with a post-season tournament to follow! The season starts in May and runs till the tourney in August. *Contact Chadd Glupker at 454-2072.*

**Football** Each fall a Flag Football league and tournament are organized. Over twenty teams are involved annually in these games designed for our community. Leagues begin in September and the tournament is in early October. *Contact the Outreach Office at 243-3674.*

**Basketball Leagues & Tournament** Several ABF's have teams of men involved in Basketball Leagues. A 3 on 3 Basketball Outreach Tournament takes place each April. *Contact Mark Sallee at 458-7639.*

**Paintball Tournament** Outreach paintball tournaments are featured at each year. This year a tournament will be held on May. *Contact the Outreach Office at 243-3674.*

**Men's Retreat** Once a year all the men of CBC congregate to relax, fellowship, mingle and study God's Word together at Camp Calvary. This year it is September 28-29. *Contact the Church Office at 243-3674.*

**Men's Bible Study** - Every Wednesday night men from CBC get together for a Bible Study. These studies provide men with an excellent opportunity to study and develop lasting friendships. *Contact Roger Hollis at 957-0914.*

**Pastor's Prayer Partners** These men meet to further the work of the local church, encourage the senior pastor's ministry and pray for his personal needs and protection. This ministry has been in existence in our church for four years and has grown to include seventy-five men. *Contact Steve Adams at 534-6066.*



**Coed Softball League & Tournament** CBC has 4 coed slow pitch softball teams that compete each summer in a 10-game season followed by a post-season tournament! *Contact Chadd Glupker at 454-2072.*

**Aerobic Kickboxing** Ladies participate in aerobic kickboxing each Tuesday night from 7-8:00 pm at the church. Fall & spring. *Contact Heidi Bixby at 261-0853.*

**Evening Connections** An evening Bible Study for women ages 19-90! Come share a cup of coffee, fellowship and enjoy a Bible study. 6:45-8:15 pm on Wednesday nights. *Contact Jane DeGroot at 940-6014.*

**Connections** Develop relationships of encouragement through practical application of God's Word. 9:00 - 11:30 am on Tuesday mornings, spring & fall. *Contact Jane DeGroot at 940-6014.*

**Women's Missionary Fellowship** Women of all ages can join in praying for and serving our church-sponsored missionaries. The ladies meet the second Monday of each month at 7:00 pm and the third Thursday of each month at 9:00 am. *Contact Mary Miller at 452-0239.*

**Women's Retreat** Every other year the women of Calvary Baptist spend a weekend fellowshiping together at an area conference/retreat center. Watch for information concerning the retreat coming up in 2002.





At Calvary Baptist Church, we are committed to helping people grow spiritually. We encourage you to try one of these programs designed to strengthen your growth in Christ.

**Parents Encouraging Parents (P.E.P.)** PEP provides a network for parents of teens to be mutually encouraged and supported through Biblical instruction and group interaction. 6:45 - 8:15 pm, Wednesday nights, fall & spring. Contact the church office at 243-3674.

**Family Camp** Spend time with your family in the great outdoors! Good food, good speakers, and great fun. You set the pace, we provide the opportunities: fellowship, canoeing, fishing, sailing, swimming, volleyball, relaxing, and much more. June 25-30 and July 16-21. Contact Evelyn at 243-3674.

**Sunday Worship & Wednesday Night Activities** Join us on Sunday for a great time of worship (for believers) filled with praise and worship music. This is our main event for spiritual growth. Mid-week is the place to be for those who are committed to growing in their faith. Wednesday nights are filled with life-challenging, growth-encouraging Bible studies and activities. Contact the Church Office at 243-3674.

**Adult Bible Fellowships** Help you and everyone in your family become an intimate part of our large congregation. The Bible is the core of the curriculum, and fellowship is the core of the activities. Stop in at the Visitors Center or call Evelyn Fitch at 243-3674.

**Growth Groups** Exist to build Christ-centered relationships in the context of a small group that will stimulate mutual learning, caring, and ministry. 6:45 - 8:15 pm, Wednesday nights, fall & spring. Contact Evelyn Fitch at 243-3674.

**Christianity 101** This class is designed for new believers and meets each Sunday morning. Contact Tim & Beth Nesseth at 669-6873.

**Growing In Christ 1 on 1 Bibles Studies** Book one covers Lessons on Assurance (salvation, answered prayer, victory over sin, forgiveness, and guidance). Book two covers Lessons on Christian Living (apply God's principles in the maturing Christian Life). Contact the Outreach Office at 243-3674.

**New Hope Through Grief** Solid Biblical help for all people who have experienced any kind of significant loss, by death, divorce, separation, broken engagement, or any other traumatic event. 6:45 - 8:15 pm, Wednesday nights. Contact Pastor Van Norman at 243-3674.

**Pre-Marital Seminar** Each year a seminar is designed by the CBC pastoral team to help young couples begin their adventure of marriage on the right foot! The next pre-marital seminar is scheduled for June 16. Contact Evelyn at 243-3674.

**Discovery** Determine how God has uniquely prepared you to serve in the church body and maximize your effectiveness. Covers six areas: Spiritual gifts, Ministry passion, Temperament, Spiritual maturity, Talents, Abilities, Skills and Scheduling. Discovery will be offered on Wednesday nights May 2-June 27 and again in the fall. Contact Chester & Donna Harris at 245-7412 or the Church Office at 243-3674.

**Special Events Ministry** This ministry serves as the consultant to the families of CBC and ministers both inside and outside our church in regard to weddings, receptions, and banquets. They also manage the kitchen for effective use. Contact Cathy VandenToorn at 698-9668.

**New Believers Bible Study** For those of you who are just beginning in the faith, it's the best place to get started. We will help you to get a solid grip on a few of the basic assurances that every Christian needs to grow. You'll also have an opportunity to ask questions about the Bible, Jesus and your faith. Join one of the groups meeting Sunday mornings 11:15-12:15, 6-7:00 pm or Wednesday nights, 7-8:00 pm. Contact the Outreach Office at 243-3674.

**Crown Financial Study** This small group study guides you in establishing Biblical and practical principles that will help you gain financial health. Groups are organized in the fall and spring. Contact Roger Berry at 243-3674.

**Adult Senior Fellowship** This program is open to anyone 55 and over. You do not need to be a church member to participate. They gather for a variety of fun-filled activities on the third Friday of each month. The group starts at 10:00 am and enjoys a delicious lunch afterward. Contact Bob Nusca at 532-0430.

**Fellowship** Meeting in various communities, these groups include couples and singles who fellowship and study God's Word together. They minister to one another's needs and share each other's joys! Some specialized affinity groups are for Women, Men, New Believers, etc. For more information call 243-3674.



**CBC Food Ministry** Reaching out to our community with free food on a regular basis. This ministry is a ton of fun! Those needing food call 243-6469. To help distribute food contact Don Scott at 281-3209.

**Servant Outreach Teams** Learn to share your faith using an easily-recalled Gospel presentation. 6:30 - 8:30 pm, Monday, Tuesday and Wednesday evenings. Contact Frances Gleghorn at 243-3674.

**Random Acts of Kindness** Teams of people reach out to our community with free soft drinks and popsicles as random acts of kindness each summer. Contact Pastor Scott Bixby at 243-3674.

**Outreach Volunteers** Volunteers are needed to do a variety of jobs indirectly touching lives for the Lord. Set your own hours at home or in the Outreach Office! Contact Linda at 243-3674.

**Puppet Outreach Team** Be a part of this team as they reach out to our community using puppet shows. Contact Beth Nesseth at 669-6873.

**New Creation Prison Ministries Outreach** CBC men weekly visit the Ionia Prison to share their faith. Tuesday - Friday 12-5:00 pm. Contact Gene Goulooze at 942-8502.

**Alpha Prison Ministries Outreach** One on One discipleship follow-up is also done weekly at the Ionia Prison by CBC men. Contact Ken Phillips at 676-1695.

**Jamaica Mission Team** Each year a group spends two weeks ministering in Jamaica. Contact Mary Kleis at 669-2734.

**Other Short-Term Missions Trips** Contact Mark Sigmon (457-6014) about the possibility of going to a foreign field on a trip! We have groups headed to Jamaica, Italy, and Portugal during the upcoming summer months.

**Sharing Jesus Without Fear** Watch God change lives as you share Christ with them. Monday, Tuesday and Wednesday evenings in the summer. Contact Frances Gleghorn at 243-3674.



**Adult Senior Fellowship** Ages 55 and over meet the third Friday of every month in room 17/19. Meetings begin at 10:00am with lunch at noon. You'll enjoy a variety of interesting topics and speakers. Contact Bob & Jimmie Nusca at 532-0430.

**Premarital Counseling and Classes** Provided by trained counselors for those who will be married at Calvary Baptist Church. Contact the Church Office at 243-3674.

**Counseling** Our lay counselors and pastors are happy to meet with anyone needing Biblical counseling. Should there be a need for long-term counseling, a list of licensed counselors from the area is available upon request. Call for appointments 243-3674.

**Prayer Hot Line** A group of dedicated men and women join our staff in praying for immediate and weekly prayer requests. These needs are called in and passed along over the phone hot line. Contact 243-3674 with urgent prayer requests.

**Hospital Home Visitation** In addition to the visits made by our pastors, representatives of CBC visit those who are hospitalized, homebound, or in convalescent homes. They encourage, read Scripture, and pray with those who are ill and recovering from illness. Contact Pastor VanNorman at 243-3674.

**Membership** If you are interested in joining the church, contact Pastor VanNorman at 243-3674, for membership class dates.

**L.I.F.T. Ministry** Loving Individuals in Final Transition helps the terminally or chronically ill by supporting the professional care giver. Contact Jennifer Comegys at 891-1516 or Donna Harris at 245-7412.



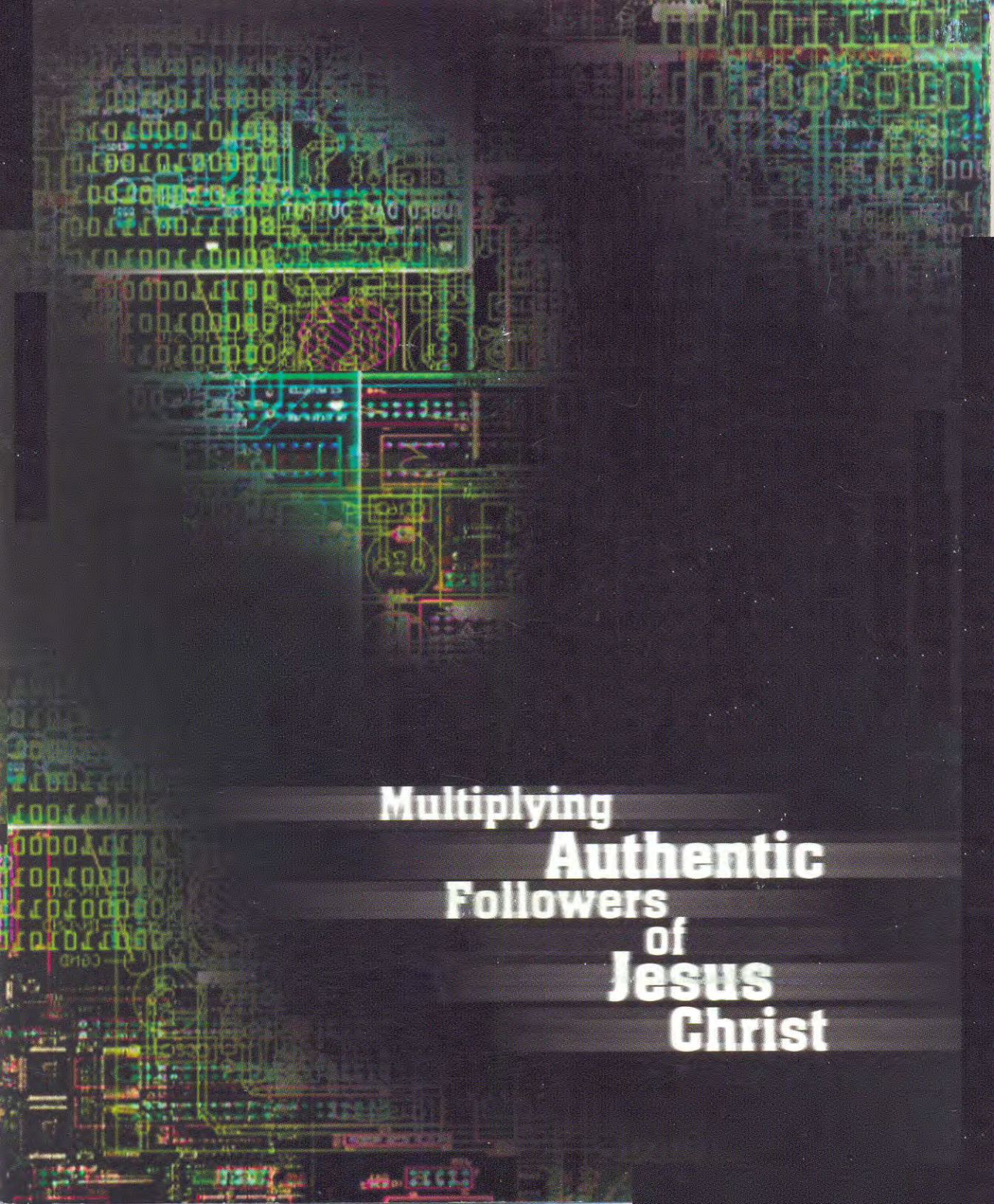

**Multiplying  
Authentic  
Followers  
of  
Jesus  
Christ**



Easter Celebration  
2001



New Hope Christian Fellowship

## Welcome To New Hope!

We're so glad you said "Yes!" to God's invitation to be with us this Easter! If this is your first visit or if you would like more information on New Hope, please fill out the Communication tab attached to the right and drop it in the offering container, or visit the Connections tent or any of the ministry tables after the worship service.

Do you need someone to pray with you, or someone to talk to? Our Prayer Advisors are available to pray with you after each service. They will be at the stage area in front of the arena.

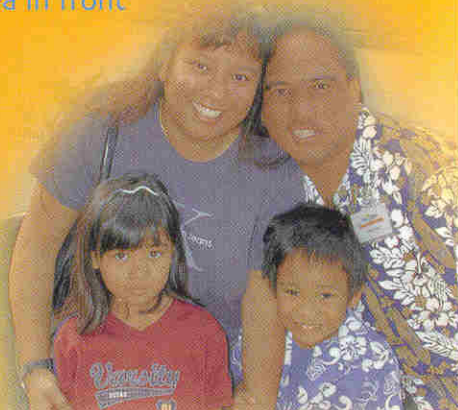

## Happy Easter!



Easter is one of the greatest parties heaven ever throws. I mean, the first Easter morning when they went to Jesus' tomb and found He had risen, there must have been the most impressive fireworks show lighting up the entire universe for all of eternity! Why? Because God won - He conquered our sin, He was victorious over death and championed eternity forever.

Easter is the symbol of life and hope; the assurance there's something beyond this life... something you and I can hope for with all of our hearts. So "Happy Easter" to each and every one of us. May we all experience the jubilant celebration of what today truly means!

*Celebrating with Our Utmost!*

A handwritten signature in black ink that reads "Pastor Wayne Cordeiro". The signature is written in a cursive, flowing style.

Pastor Wayne Cordeiro

### WEEKEND SERVICES:

Weekend services are held on Saturday evenings and Sunday mornings. Our Saturday evening services are at 5:00 & 7:00 p.m. at Farrington High School. Our Sunday morning services are at 7:00, 9:00 & 11:00 a.m. at Farrington High School, and 8:00 & 10:00 a.m. at our Ministry Center. We offer Chinese translation at our Saturday, 7:00 p.m. service; Japanese translation at our 9:00 & 11:00 a.m. service and Hearing Impaired translation at our 11:00 a.m. service.

### WEDNESDAY L.E.A.D. SERVICE:

Join us during the week for a refreshing time of worship and teaching. We meet on Wednesday evenings at 7:00 p.m. at our Ministry Center.

### MINISTRIES:

New Hope is home to over 100 different ministries and dozens of home-based Small Groups. If you have a particular talent or interest, you'll more than likely find a ministry just for you. Stop by our Connections tent for more information.

### RADIO & INTERNET MESSAGES:

Catch Pastor Wayne on the radio and internet. Radio messages are Monday - Friday at 5:00 p.m. & 1:00 a.m. on KAIM 870 AM, and Sunday at 8:00 a.m. on KUMU 1500 AM. Internet messages are at [www.managinglife.net](http://www.managinglife.net) Monday - Friday at 1:00 a.m. & 1:00 p.m.



GET CONNECTED

Call the Ministry Center at 842-4242 for all phone extensions listed below. The Ministry Center and the LEAD Center are at 290 Sand Island Access Road.

### CHILDREN'S MINISTRY

Gale Siu 672-3077

#### Children's Ark

From birth to fifth grade, we cater to your child's needs. Classes include worship, Sunday school curriculum and activities for learning and fun.

### JR. HIGH (GR 6-8)

Blaine Santa Monica x323

#### The Next Generation -Jr. High

Fridays, 7 p.m. at the LEAD Center  
Sundays, 9 a.m. at Farrington High School's cafeteria

Jr. Highers! Come to "The Next Generation." It's a place for you!

### HIGH SCHOOL (GR 9-12)

Andy Kakutani x322

#### Pure Heart Night

Fridays, 7:11 p.m. at the LEAD Center

Join us for an awesome time of worship, fellowship and learning more about Jesus! We're continuing our "Chasing the Father's Heart" series.

### XTREME (AGES 18-40)

Lynn Kelly x413

[www.XtremeHawaii.org](http://www.XtremeHawaii.org)

#### Thursdays at Xtreme

7:00 p.m. at Moanalua High School

Our "It Takes Three" relationship series continues. Ms. Hawaii, Billy Takaki, will be sharing her testimony.





### **Aerobics Ministry**

*Fridays 5:30 p.m. at the Ministry Center*

*Alva Kaua 676-7361*

Enhance your cardiovascular, increase stamina, maximize your physical appearance and most of all have fun!

### **Hungry for His Presence (HFHP) - April 22**

*9:00 a.m. at Farrington High Mike Ward x351*

There's still time to sign up for our next Adult Sunday School session. Choose between HFHP 101 "Loving God," HFHP 102 "Loving Growth" and HFHP 103 "Loving Others." Class synopses and registration forms are available at the Connections tent.

### **Kokua Pantry**

*Pat Kopa 239-1149*

*Kim Preza 623-3333*

Extend a helping hand to families in need. Donate dry or canned food and clothing (extra large sizes especially needed). Drop them off at the Mercy Ministries office at the Ministry Center.

### **Medical Professionals!**

*Glenn Lockwood x430*

Our emergency medical response team needs quality professionals to volunteer for coverage in our services. Are you available? Would you like to help? Ask any usher for an information packet.

### **Thailand Ziploc Project**

*Debbie Herrera 423-2327*

We're collecting children's clothes to bring on our mission trip. Put the clothes in a ziploc bag, label the size and gender, and drop them at the Children's Ark information table.



## **Communication Tab**

I would like to volunteer my time serving in the following ministry:

- |  |   |
|--|---|
| <input type="checkbox"/> Adoption                | <input type="checkbox"/> Lighting                             |
| <input type="checkbox"/> Baptism                 | <input type="checkbox"/> Marriage Builders                    |
| <input type="checkbox"/> Bookstore               | <input type="checkbox"/> Mechanics                            |
| <input type="checkbox"/> Children's              | <input type="checkbox"/> Men's                                |
| <input type="checkbox"/> Choir                   | <input type="checkbox"/> Mercy Ministries                     |
| <input type="checkbox"/> Cistern Servants        | <input type="checkbox"/> Missions                             |
| <input type="checkbox"/> Conferencing            | <input type="checkbox"/> Office Ministry                      |
| <input type="checkbox"/> Cooking                 | <input type="checkbox"/> Pac Rim Bible Institute              |
| <input type="checkbox"/> Dance                   | <input type="checkbox"/> Parking                              |
| <input type="checkbox"/> Database                | <input type="checkbox"/> Photography                          |
| <input type="checkbox"/> Deaf                    | <input type="checkbox"/> Prayer                               |
| <input type="checkbox"/> Drama/ Programming      | <input type="checkbox"/> Prison                               |
| <input type="checkbox"/> Experiencing God        | <input type="checkbox"/> Rebuilders (12 Step/ Support Groups) |
| <input type="checkbox"/> Gen-X (18 - 40)         | <input type="checkbox"/> Singles (Crossroads 33+)             |
| <input type="checkbox"/> Greeters                | <input type="checkbox"/> Small Groups                         |
| <input type="checkbox"/> Hawaiian Music          | <input type="checkbox"/> Sound                                |
| <input type="checkbox"/> High School             | <input type="checkbox"/> Sports Ministries                    |
| <input type="checkbox"/> Ho'okele (Publications) | <input type="checkbox"/> Tape Ministry                        |
| <input type="checkbox"/> Hospital                | <input type="checkbox"/> Ushers                               |
| <input type="checkbox"/> Hospitality             | <input type="checkbox"/> Video/Multimedia                     |
| <input type="checkbox"/> Japanese                | <input type="checkbox"/> Web Ministry                         |
| <input type="checkbox"/> Junior High             | <input type="checkbox"/> Women's                              |
| <input type="checkbox"/> Karaoke                 | <input type="checkbox"/> Youth Choir                          |
| <input type="checkbox"/> L.E.A.D.                |   |
| <input type="checkbox"/> Levites                 |   |

(Set up/Take down)

Refer to the ministry list in this quarter's Ho'okele or visit the Connections tent for a complete listing.

### **Hospital Visitation Requested**

Please visit:

Hospital and room #

Condition

Relationship

Phone number to arrange visitation:



## Communication Tab

We'd like to get to know you better! Please complete this slip and place it in an offering basket. Thank you!

Name \_\_\_\_\_ Prayer requests: \_\_\_\_\_

Address \_\_\_\_\_

City/State/Zip \_\_\_\_\_

Home Phone \_\_\_\_\_ TDD \_\_\_\_\_

Day Phone (if other) \_\_\_\_\_ TDD \_\_\_\_\_ Praise reports: \_\_\_\_\_

Email \_\_\_\_\_

### For our visitors...

- I am visiting New Hope for the first time.
- I am looking for a home church.
- I currently attend another church.
- I am visiting from out-of-town.
- Please add me to your mailing list.

### For our regular attendees...

- I would like information on becoming a member of New Hope.
- I am a new believer in Jesus Christ...

Please help me take the next steps.

I would like to speak with someone about:

- Joining a Small Group.
- Becoming a Christian.

New Hope Christian Fellowship O'ahu  
"A Foursquare Gospel Church"

Wayne Cordeiro, Senior Pastor  
290 Sand Island Access Road  
Honolulu, HI 96819  
(808) 842-4242, Fax (808) 842-4241,  
[www.eNewhope.org](http://www.eNewhope.org)

Easter Celebration  
2001



New Hope Christian Fellowship

# Communication Tab

We'd like to get to know you better! Please complete this slip and place it in an offering basket. Thank you!

Name \_\_\_\_\_

Prayer requests: \_\_\_\_\_

Address \_\_\_\_\_

City/State/Zip \_\_\_\_\_

Home Phone \_\_\_\_\_

TDD \_\_\_\_\_

Day Phone (if other) \_\_\_\_\_

TDD \_\_\_\_\_

Praise reports: \_\_\_\_\_

Email \_\_\_\_\_

For our visitors...

- I am visiting New Hope for the first time.
- I am looking for a home church.
- I currently attend another church.
- I am visiting from out-of-town.
- Please add me to your mailing list.

For our regular attendees...

- I would like information on becoming a member of New Hope.
- I am a new believer in Jesus Christ...

Please help me take the next steps.

I would like to speak with someone about:

- Joining a Small Group.
- Becoming a Christian.

New Hope Christian Fellowship O'ahu  
"A Foursquare Gospel Church"

Wayne Cordeiro, Senior Pastor  
290 Sand Island Access Road  
Honolulu, HI 96819

(808) 842-4242, Fax (808) 842-4241,  
[www.eNewhope.org](http://www.eNewhope.org)



## Links to additional materials to train, equip, and encourage Church Communicators from : Yvon Prehn and Effective Church Communications

Effective Church Communications Training website:  
<http://www.effectivechurchcom.com>

The Effective Church Communications website has articles, many training videos, ready-to-print templates and PDFs for church communicators. It has hundreds of entries that can do everything from equip a beginning church communicator to challenging a senior staff member to be more effective in their church communications. Please sign up for our email updates and you'll get short notices each week on new material posted on the site.

### Yvon Prehn's books in paperback

A growing selection is available at <http://www.amazon.com>. Just enter "Yvon Prehn" in the search box to go to her list of books.

The regular amazon pricing, shipping, free shipping offers apply.

If you would like to purchase books in bulk at a reduced price, or are interested commissioning a Personalized Special Edition for a training event or conference, contact [yvon@effectivechurchcom.com](mailto:yvon@effectivechurchcom.com).

### To stay connected, get notices of new materials and resources and to be challenged in church communications:

Yvon Prehn's blog: <http://www.churchcommunicationsblog.com>

Twitter: <http://www.twitter.com/yvonprehn>

Facebook: <http://www.facebook.com/EffectiveChurchCommunications>

YouTube videos: <http://www.youtube.com/yvonprehn>

LinkedIn: <http://www.linkedin.com/in/yvonprehn>

### Digital versions and downloadable e-books are available from:

Smashwords: <https://www.smashwords.com/profile/view/yvonprehn>

This site has lots of free special edition ebooks. It also allows you to download books in any ebook format. New ones are continuously added, so check back frequently. ***Please pass on this link to church, mission, and other groups for the free downloads.***

Yvon's digital books are also available from these major online and retail sources, just put "Yvon Prehn" into their search function to find the books. These selections are added to frequently, so check back for new titles.

**www.amazon.com:** Kindle versions for download to the Kindle reader available here

Itunes online bookstore

Barnes and Noble online bookstore

### Contact information

For additional questions about the Effective Church Communications ministry, to request free reprint permission of articles, for interviews or contributions to websites or books, email: [yvon@effectivechurchcom.com](mailto:yvon@effectivechurchcom.com).

---

Enabling your church to create communications that  
Fully fulfill the Great Commission  
<http://www.effectivechurchcom.com>